

**Lots and Land**

**MLS 179339**

**Status Active**

**Price \$695,000**

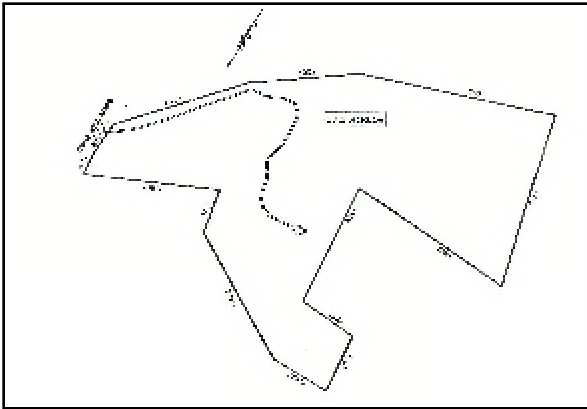

Address **Cone Hill Rd.**  
**Richmond MA 01254**

Agent Related **No**  
  
Region **Central Berkshire**  
Zoning **Residential**  
\*Book **35**  
\*Page **199**  
\*Map Ref **M:4110 B:0030 L:40000**  
\*Tax Year **2007**  
\*Taxes \$ **\$2,591**

[Photos](#)

[Map](#)

Lot Size Apx  
Acres Apx **37.33**  
Frontage Apx **300.00**  
Elem School **Richmond**  
Middle School **Richmond**  
High School **choice**  
\*Assess Amt \$ **\$333,100**  
\*Assess Year **2003**  
Betterment  
Restrict Covenants **Unk**  
Title V **Pass**  
Title V Date  
Undergrnd Tank **Unk**

Water **None**  
Sewer **None**  
Views  
Waterfront  
Subdivided  
Perc **Yes**  
Perc Date  
Soil Evaluation  
Land Use  
  
Lot Info  
  
Exterior Amenities  
  
Seller Discl **No**

Public Remarks **Beautiful, private 37.33 acres. Driveway gently winds to a lovely building site. Beautiful variety of trees. Gorgeous boulders scattered throughout the property. Delightful walking trails. Winter views. A true scantuary. Septic design for a 4-bedroom house is available.**

Directions **Swamp Rd north from center of West Stockbridge, left fork onto Cone Hill Rd. Property on the right. See sign.**