

Lots/Land

MLS# 192903

Status: Active

List Price: 219,500

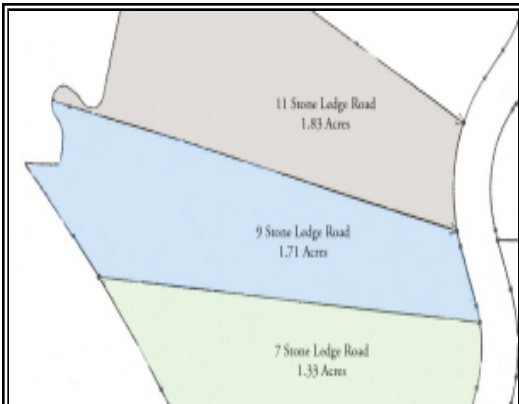

Address: 9 STONELEDGE Rd Lenox, MA 01240

Agent Related: No
 Region: Berkshire - South
 Village:
 Book:
 Page:
 Map Ref:
 Tax Year: 2010
 Taxes: 3,192

Lot Square Footage: 72777
 Acres Apx: 1.71
 Frontage Apx:
 Elem School: Morris
 Middle School: Lenox Memorial
 High School: Lenox Memorial
 Assess Amt: 321,800
 Assessed Year: 2,010
 Betterment:
 Telephone Pole Coord:
 Contingent:
 Contingent Remarks:

Views:
 Waterfront:
 Land Use:
 Zoning: Residential
 Subdivided: Yes
 Lot Info:
 Water: Public
 Well Detail:
 Sewer: Public
 Underground Oil: No
 Tank:
 Seller Disc:
 Lot Description: Subdivision
 Restrict Covenants: Yes
 Right to Farm: No
 Comm:
 Soil Evaluation Rpt: No
 Title V: Not Applicable
 Title V Date:
 Perc: No
 Perc Date:
 Exterior Amenities: Cable Avail; Gas Avail; Paved Roads; Phone Avail; Trees; Water-On Site

Public Remarks: Excellent lot with town water/sewer and natural gas available in an exclusive neighborhood a short distance to the center of Lenox.

Directions: Rte. 7 North to right on Housatonic St. Stone Ledge is first road on left.