

Lots/Land

MLS# 192907

Status: Active

List Price: 199,500

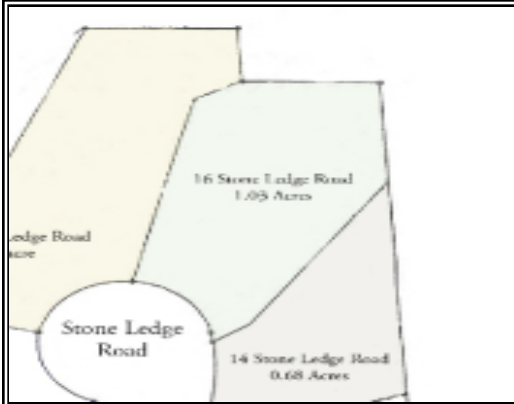

Address: 16 STONELEDGE Rd Lenox, MA 01240

Agent Related: No

Region: Berkshire - South

Village:

Book:

Page:

Map Ref:

Tax Year: 2010

Taxes: 3,156

**Lot Square Footage:** 43836  
**Acres Apx:** 1.03  
**Frontage Apx:**  
**Elem School:** Morris  
**Middle School:** Lenox Memorial  
**High School:** Lenox Memorial  
**Assess Amt:** 318,100  
**Assessed Year:** 2,010  
**Betterment:**  
**Telephone Pole Coord:**  
**Contingent:**  
**Contingent Remarks:**

**Views:**  
**Waterfront:**  
**Land Use:**  
**Zoning:** Residential  
**Subdivided:** Yes  
**Lot Info:**  
**Water:** Public  
**Well Detail:**  
**Sewer:** Public  
**Underground Oil Tank:** No  
**Seller Disc:**  
**Lot Description:** Subdivision  
**Restrict Covenants:** Yes  
**Right to Farm Comm:** No  
**Soil Evaluation Rpt:** No  
**Title V:** Not Applicable  
**Title V Date:**  
**Perc:** No  
**Perc Date:**  
**Exterior Amenities:** Cable Avail; Gas Avail; Paved Roads; Trees; Water-On Site

**Public Remarks:** Excellent lot in an exclusive neighborhood a short distance to the center of Lenox. Town water/sewer and natural gas available.

**Directions:** Rte. 7 North to right at Housatonic St. Stone Ledge is the first road on the left.