

Lots/Land

MLS# 192906

Status: Active

List Price: 199,500

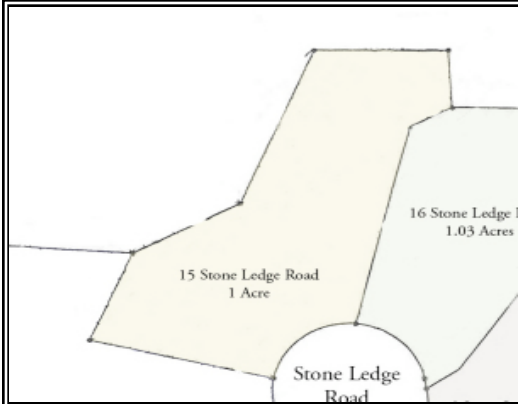

Address: 15 STONELEDGE Rd Lenox, MA 01240

Agent Related: No

Region: Berkshire - South

Village:

Book:

Page:

Map Ref:

Tax Year: 2010

Taxes: 2,988

Lot Square Footage: 42560
Acres Apx: 1
Frontage Apx:
Elem School: Morris
Middle School: Lenox Memorial
High School: Lenox Memorial
Assess Amt: 301,200
Assessed Year: 2,010
Betterment:
Telephone Pole Coord:
Contingent:
Contingent Remarks:

Views:
Waterfront:
Land Use:
Zoning: Residential
Subdivided: Yes
Lot Info:
Water: Public
Well Detail:
Sewer: Public
Underground Oil Tank: No
Seller Disc:
Lot Description: Subdivision
Restrict Covenants: Yes
Right to Farm Comm: Yes
Soil Evaluation Rpt: No
Title V: Not Applicable
Title V Date:
Perc: No
Perc Date:
Exterior Amenities: Cable Avail; Curbs; Elec-On Site; Electric Avail; Paved Roads; Phone Avail; Trees; Water-On Site

Public Remarks: Great building lot in an exclusive private neighborhood just outside the village.

Directions: Route 7 North to Right on Housatonic Street. Stone Ledge Road in on the Left.